

Model YL002503-10

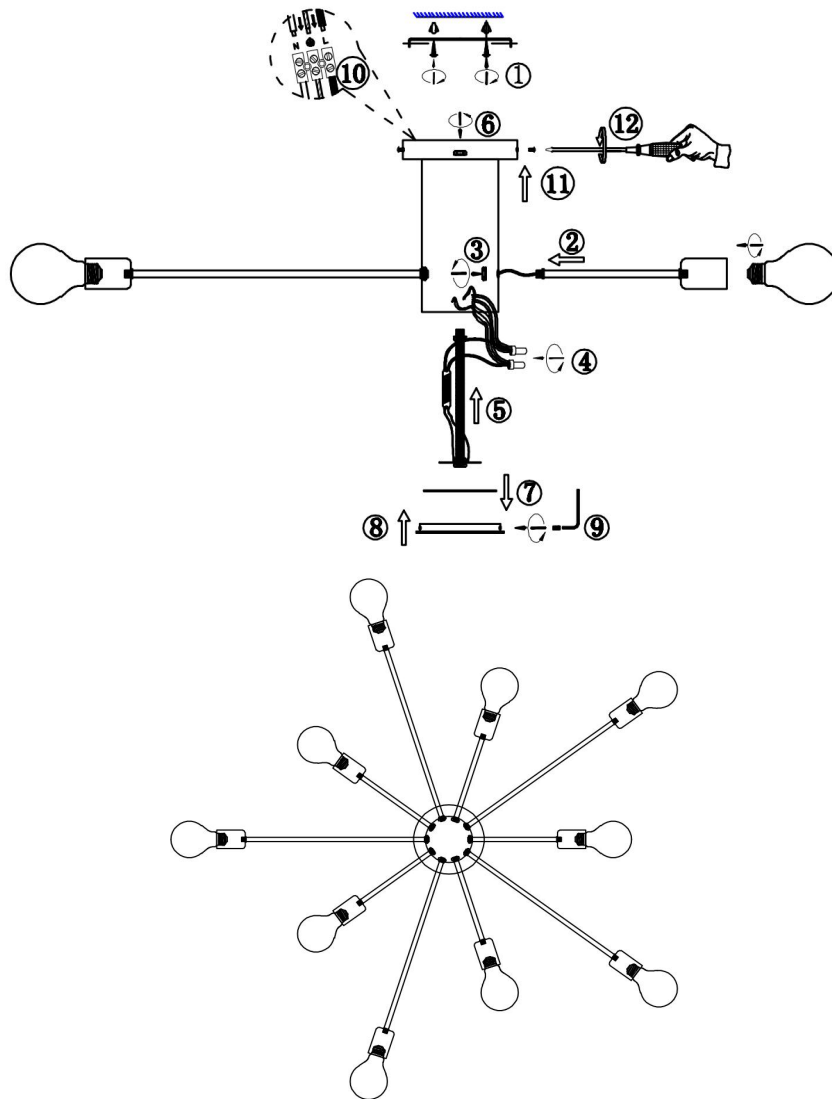

Safety Instructions:

- * These instructions are provided for your safety. It is very important that they are read completely before beginning the installation of your fixture.
- * WE STRONGLY RECOMMEND INSTALLATION BY A LICENSED ELECTRICIAN.

Assembly Instructions

1. Mark the position of the mounting plate's holes on your ceiling. Drill the holes for plastic anchors. Install provided plastic anchors into the holes you've just drilled. Mount the plate with the screws provided.
2. Screw arms to the lamp body one by one and lock tight with nuts.
3. Connect arms wires with LED driver. Sort out all wire by same colors, bundle them with wire caps. Put the led device inside lamp body and lock tight.
4. Make electrical connections. Connect BLACK/BROWN (L) wire to the L wire from power supply; WHITE/BLUE (N) wire to the N wire from power supply.
5. Mount the fixture canopy to the mounting plate by sliding the fixture cover over the mounting plate and lock from both side.
6. Put E26 (US)/E27 (EUR) bulbs on the lamp-holders and turn your power back on at the breaker box.

- * If you have any questions or any missing part, please do not hesitate to contact us.
- * To clean, wipe surfaces with a soft cloth. Do not use chemical or abrasive cleaners.